

**WATER EASEMENT NOTE**

DEDICATED EASEMENTS TO BENEFIT THE AUGUSTA WATER DISTRICT (AWD) SHALL ENCOMPASS ALL NEW WATER LINES. EASEMENTS SHALL COVER THE ENTIRE RIGHT OF WAY AND SHALL BE 20' WIDE CENTERED OVER THE LINE WHERE THE LINES ARE INSTALLED OUTSIDE THE RIGHT OF WAY PER THE REQUIREMENT OF THE AWD.

**SANITARY SEWER NOTE**

NEW SANITARY SEWER SYSTEMS SHOWN HEREON INCLUDING GRAVITY, PUMP STATION AND FORCE MAINS SHALL CONFORM TO "A" SPEC. FOR SANITARY SEWERS AND STORM DRAINS FOR AUGUSTA SANITARY DISTRICT DATED 3/1/02.

**SILT SACK REQUIREMENT**

ALL NEW CATCH BASINS TO BE FITTED WITH SILT SACKS AS DETAILED AND MAINTAINED THROUGHOUT THE CONSTRUCTION PHASE TO THE SATISFACTION OF THE CITY OFFICIALS

**LEGEND**

- ..... EXISTING UTILITY POLE
- ▭ EXISTING PAVEMENT
- ~ EXISTING TREE LINE
- ⊙ EXISTING TREE
- N/F NOW OR FORMERLY
- 3821/39 BOOK AND PAGE NUMBER
- PROPERTY LINE
- EXISTING CONTOUR
- ▭ WETLAND AREA
- ⊙ EX. CATCH BASIN
- EX. SEWER LINE
- EX. WATER SERVICE
- EX. STORM DRAIN
- NEW 4" FORCE MAIN
- NEW STORM DRAIN
- NEW 12" WATER MAIN
- NEW 4" UNDERDRAIN
- NEW CONTOUR
- ⊙ NEW CATCH BASIN
- ⊙ NEW DRAIN MANHOLE
- ⊙ NEW SEWER MANHOLE
- ▭ NEW PAVEMENT
- ~ NEW TREE LINE
- NEW GUARD RAIL
- NEW SILT FENCE

**CENTRAL MAINE COMMERCE DRIVE**

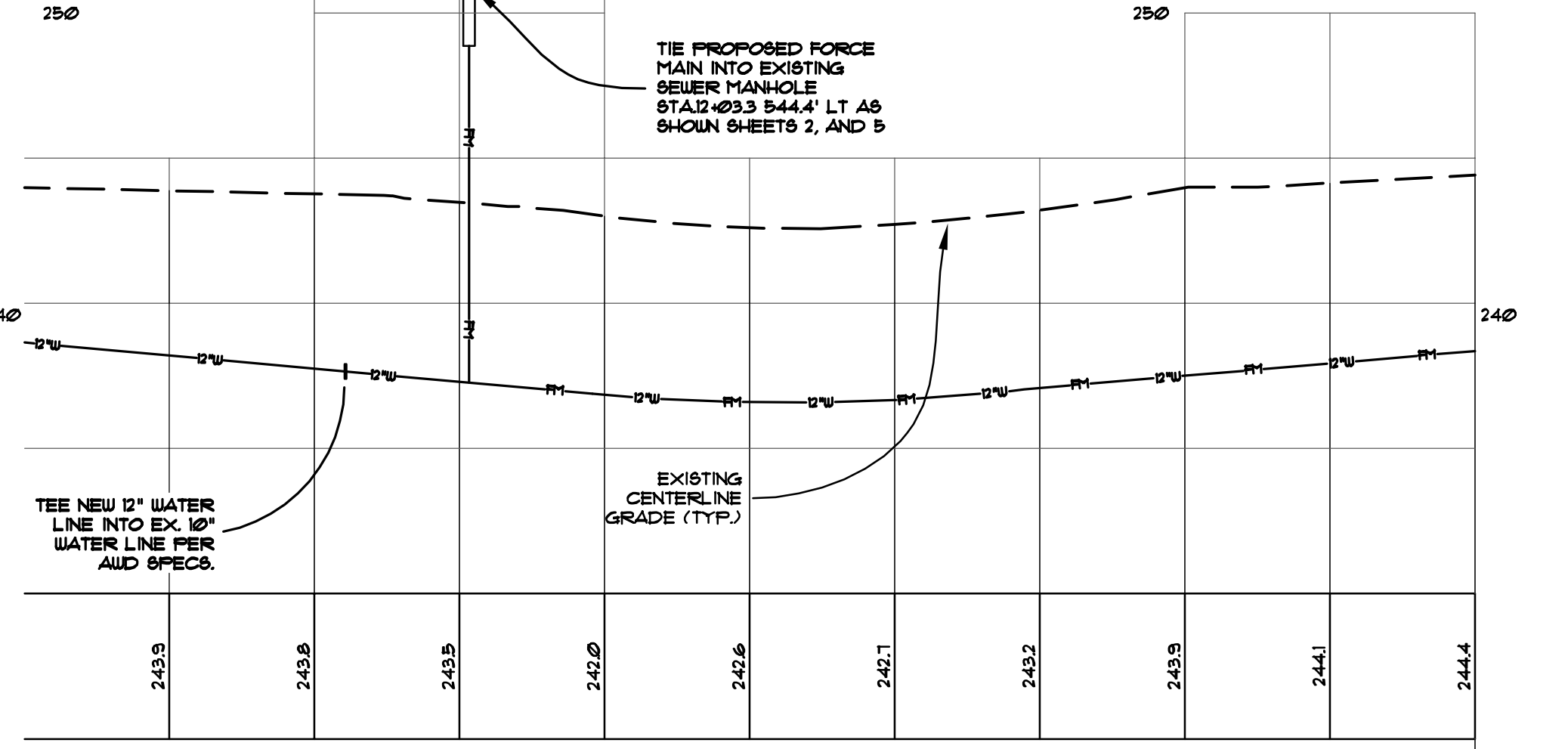
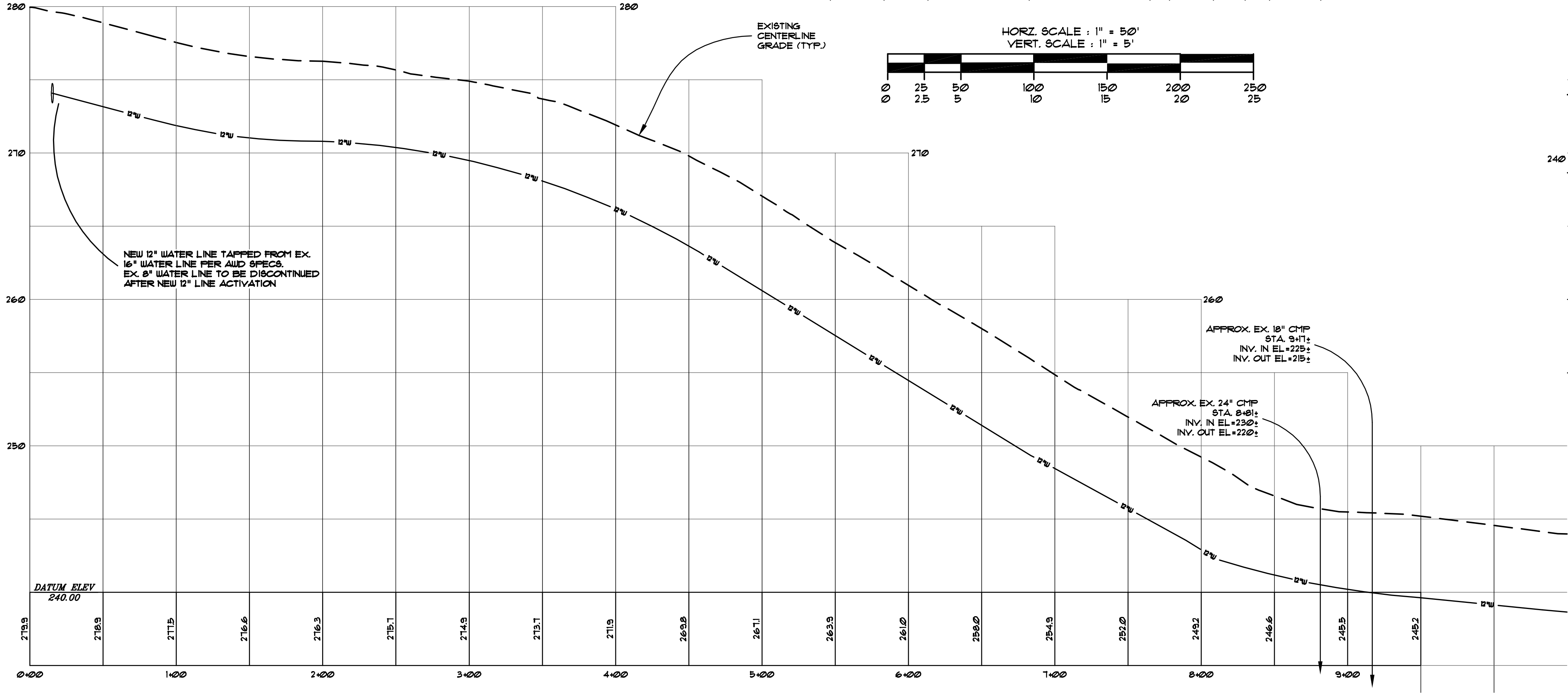

|        |   |          |  |
|--------|---|----------|--|
| REV. # | 3 | 05/10/06 | UPDATE PL, LOTS, ROW, EASE PER KF. 3/13/05 |
| REV. # | 2 | 10/18/05 | STRIPING, UTILS, ETC.                      |
| REV. # | 1 | 9/16/05  | PER D.E.P. REVIEW                          |

**PROGRESS PRINT**  
 03/10/06  
 FOR APPROVALS ONLY

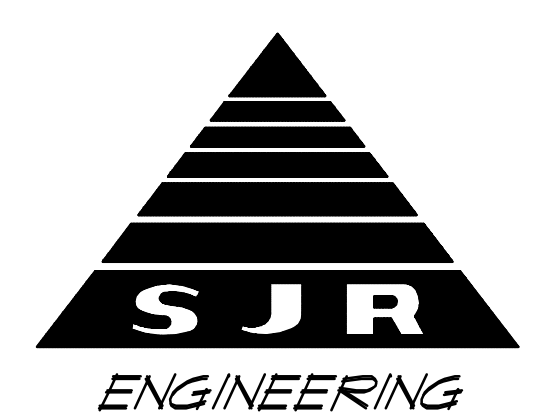

**S.J.R. ENGINEERING**  
 21 MAYFLOWER ROAD  
 AUGUSTA, MAINE  
 TEL: (207) 622-1676

PLAN AND PROFILE  
 CENTRAL MAINE COMMERCE DRIVE

**CENTRAL MAINE COMMERCE CENTER**  
 CIVIC CENTER DRIVE - AUGUSTA, MAINE  
 KENNEBEC COUNTY

SCALE : AS SHOWN      DRAWN BY : BOMAC      PROJECT : SCIPPI  
 DATE : JUNE, 2005      CHECKED BY : SJR      DRAWING : # 6