

**NOTES:**

1) THIS IS NOT A BOUNDARY SURVEY. MAP DATA ACQUIRED FROM THE CITY OF AUGUSTA WAS COMPILED USING PHOTOGRAMMETRY BASED ON AERIAL PHOTOGRAPHS. STANDARD PROCEDURE DICTATES THAT PHOTOGRAMMETRIC MAPS BE FIELD CHECKED PRIOR TO USE. THE MAP DATA IS INTENDED TO SUPPORT THE INVENTORY OF REAL PROPERTY IN THE CITY OF AUGUSTA. MAP DATA SHOULD NOT BE INTERPRETED AS THE ACTUAL FIELD SURVEY DATA. THIS DATA SHOULD NOT BE USED FOR LEGAL DESCRIPTION OR CONVEYANCE PURPOSES. THE CITY OF AUGUSTA AND S.J.R. ENGINEERING, INC. SHALL NOT BE HELD LIABLE FOR DAMAGES RESULTING FROM MAP INACCURACIES OR INCONSISTENCIES.

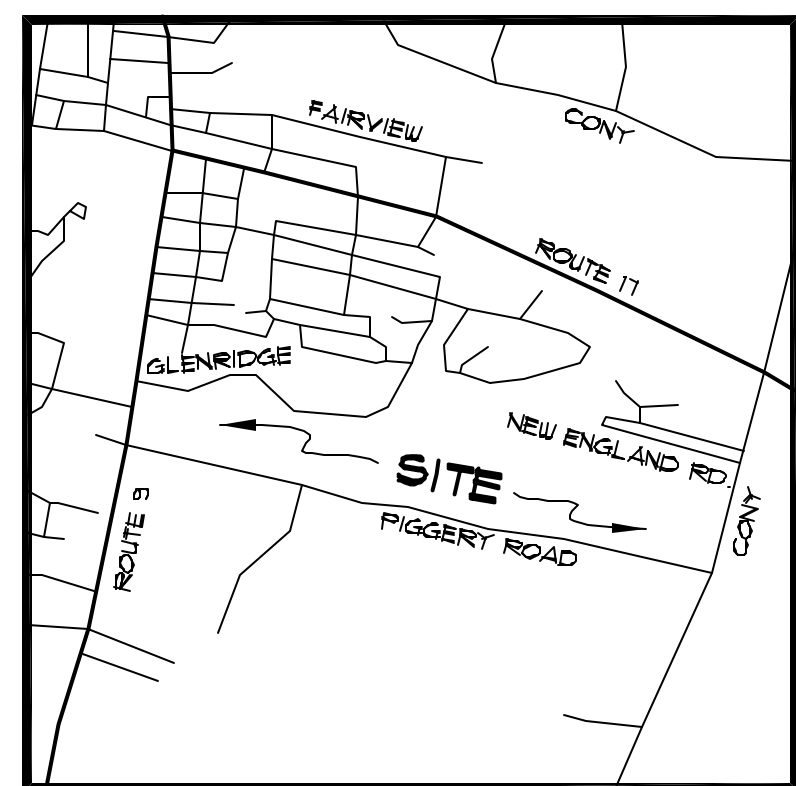
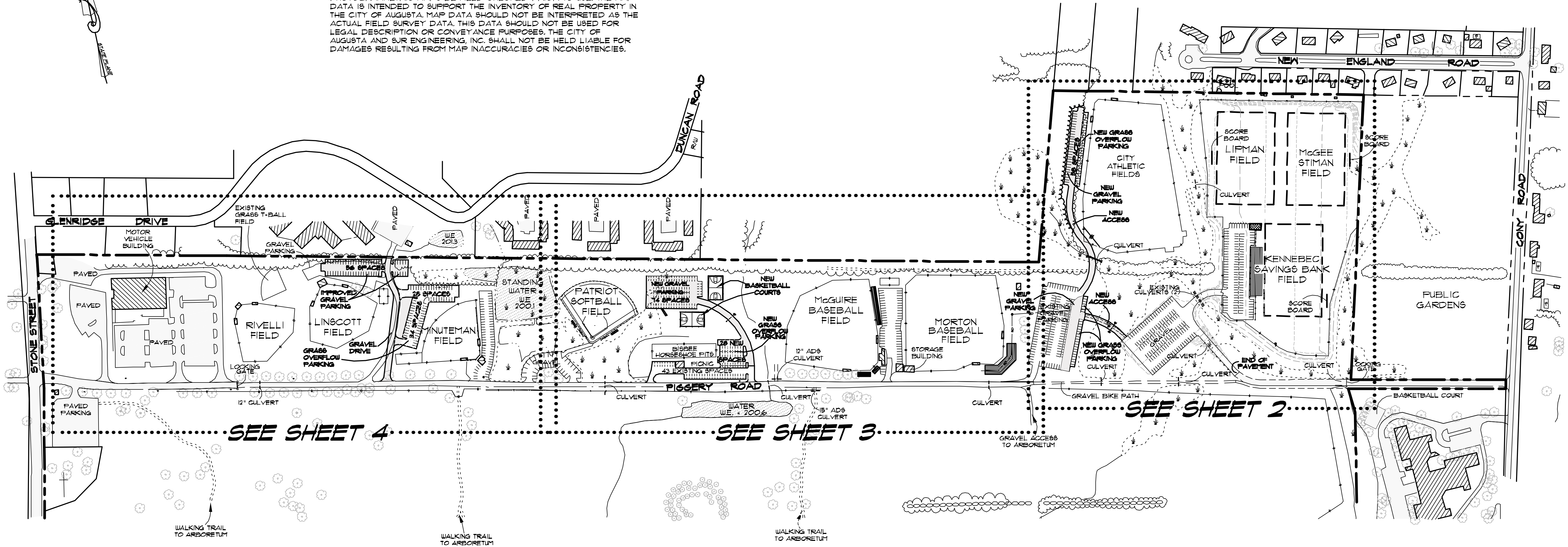

**LOCATION MAP**  
(NOT TO SCALE)

**LEGEND**

.....○.....	UTILITY POLE WITH OVERHEAD UTILITY LINES	-----220-----	EXISTING CONTOUR
.....WE.....	UNDERGROUND UTILITY LINES	26.5 x	SPOT ELEVATION
⊗	HYDRANT	-----	WETLAND BOUNDARY
⊕	WATER VALVE	▭	EXISTING PAVEMENT
⊙	DECIDUOUS TREE	▨	BUILDING
-----	CHAIN LINK FENCE	▩	STANDING WATER
○○○○○○○○	STONE WALL	▬	STANDS AND BLEACHERS
~~~~~	VEGETATION	▭	NEW GRAVEL AREA
*	LIGHT	▭	NEW GRASS OVERFLOW PARKING AREA
⊕	MANHOLE	~~~~~	NEW LIMIT OF CLEARING

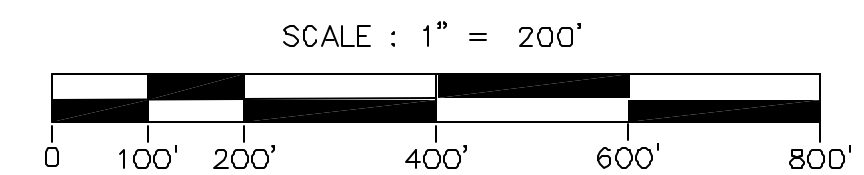

SCALE: 1" = 200'

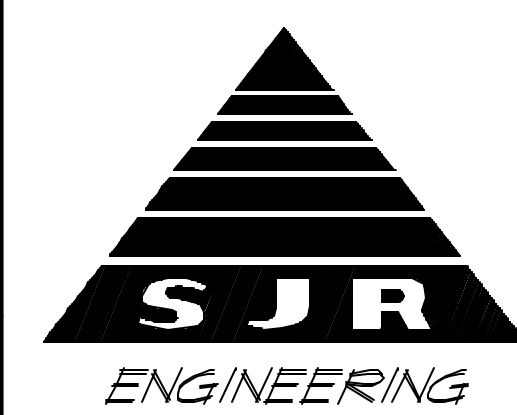

**S.J.R. ENGINEERING**

21 MAYFLOWER ROAD  
AUGUSTA, MAINE  
TEL: (207) 622-1676

**MASTER PLAN**

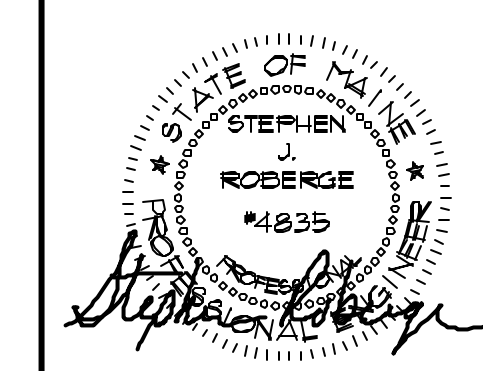

FOR APPROVALS ONLY

**CAPITOL AREA RECREATION ASSOCIATION**

FIGGERY ROAD AUGUSTA, MAINE

SCALE: AS SHOWN DATE: OCTOBER, 2003 DRAWN BY: G&B/BMC CHECKED BY: S.J.R. FILE: 030256P1 DRAWING #1 OF 4